

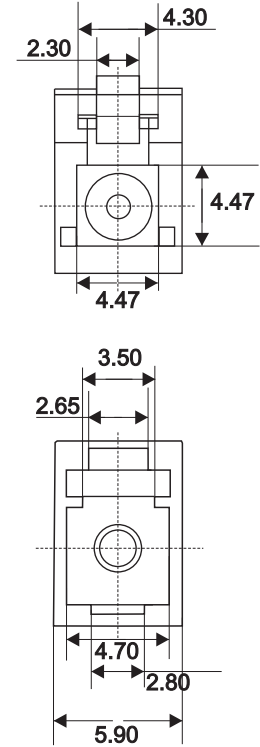

LC APC Female to LC UPC Male Singlemode 9/125 Simplex Fiber Optic Conversion Adapter

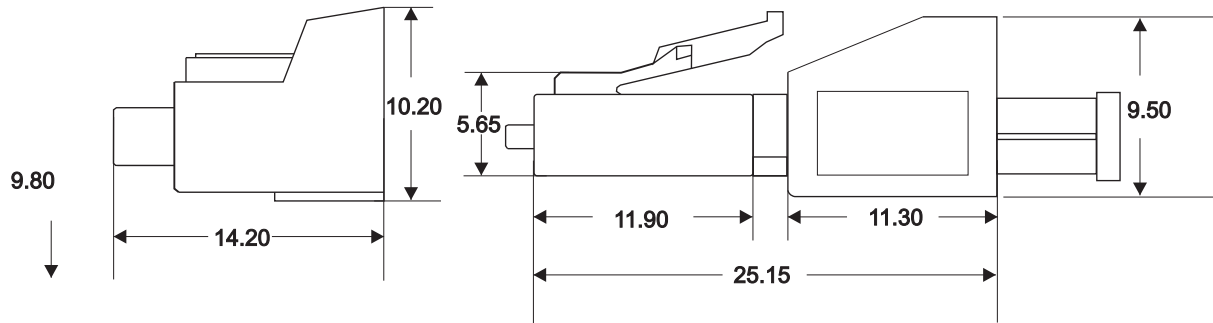
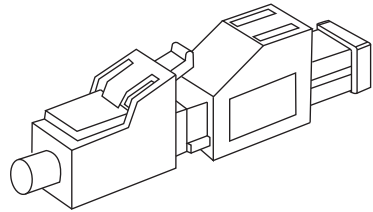

Unmarked Tolerances

- > 0-3mm ± 0.05
- > 3-18mm ±0.10 >
- 18-50mm ±0.15 >
- 50mm ±0.20

ANGLES ALL±0.5°

Technical Specifications

1. Fiber Type: Corning® fiber
2. Insertion Loss Requirement: 0 dB: +0.5 dB
3. Return Loss Standard: Singlemode UPC ≥ 45 dB; APC ≥ 55 dB
4. Test Wavelengths: Singlemode 1310 nm & 1550 nm
5. Operating Temperature: -40 °C to +80 °C
6. Appearance: Clean and smooth; free of oil, burrs, cracks, deformation, rust, or other defects
7. Color: Green and Blue
8. Compliance: Finished product meets RoHS 2.0 standards

P/N QT-FOCA-LCAF-LCUM-SM-SX

Product Title: QuickTreX® LC APC Female to LC UPC Male Singlemode 9/125 Simplex Fiber Optic Conversion Adapter

Units : mm

Third Angle Projection

